

## Data Sheet for T-AA900

### Specifications

Type :	Rechargeable Nickel- Cadmium Standard Cell
Model (P/N) :	T-AA900
Nominal Dimension : (with sleeve)	$\Phi = 14.5 \begin{smallmatrix} 0 \\ -0.5 \end{smallmatrix}$ mm H = $49.0 \pm 0.5$ mm
Applications :	Recommended discharge current 90 to 900 mA
Nominal Voltage :	1.2V
Nominal Capacity :	900 mAh when discharge at 180 mA to 1.0 V at 20°C
Standard Charge :	90 mA for 15 hrs at 20°C
Fast Charge :	360 mA (0.4C ) with charge termination control Recommended control parameters - $\Delta V$ :10 mV & $\Delta T/\Delta t$ :0.8~1°C/min Timer: 140 % nominal input
Service Life :	> 500 cycles
Continuous Overcharge :	900 mA maximum permissible current No conspicuous deformation and / or leakage
Weight :	26 g
Internal Resistance :	Max 25 m $\Omega$ at 1000 Hz measured within 1 hour after standard charge
Max. Charging Voltage :	1.5 V at 800 mA charging
Ambient Temperature : Range	Standard Charge : 0°C to 45°C Fast Charge : 10°C to 45°C Discharge : -20°C to 45°C Storage : -20°C to 45°C

### Characteristics

#### Charge Curves ( 20 °C )

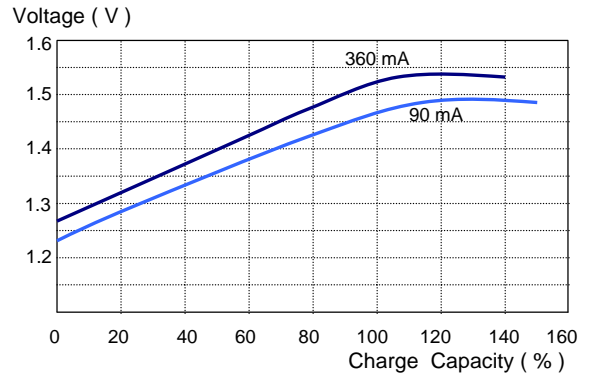

#### Discharge Curves ( 20 °C )

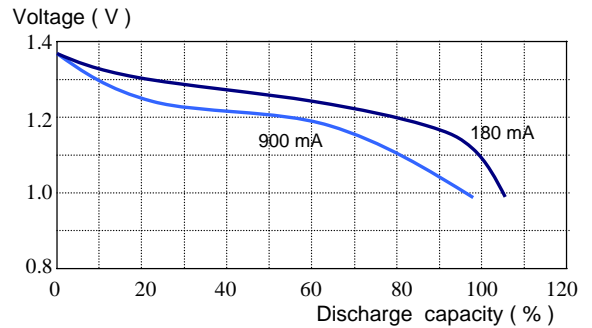

#### Charge/Discharge Efficiency vs. Temperature

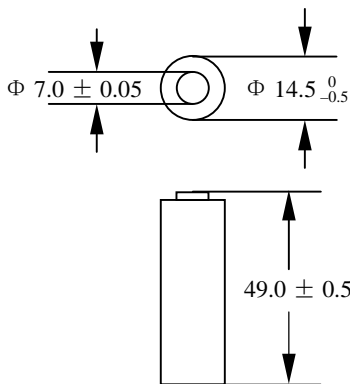
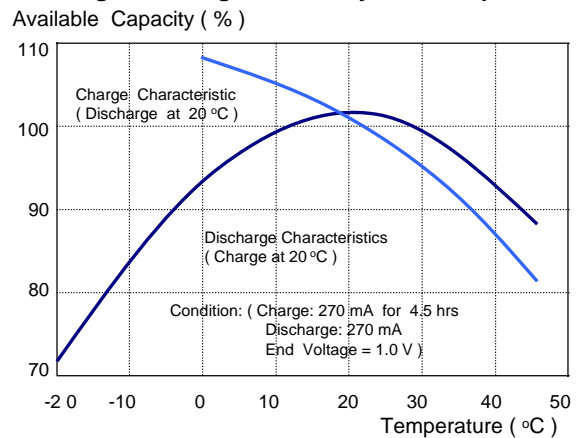

## American Toppower

Add: 2033 Route 130, Unit N, Monmouth Junction, NJ 08852.

Tel: 732-821-1000 Fax: 732-821-2000

Manufacturer reserves the right to alter or amend the design, model and specification without prior notice.